



VM-25

VM-25 Condition Monitoring System
**UPDATED
INFORMATION**

No. Item	Release Date※
1. Field Configuration Function Support for Non-Contact Displacement Transducer and Addition of Other functions	November 2018
2. Addition of Automatic Adjustment Function	January 2019

※ Release date basically refers to the month in which the new feature becomes applicable, while for a new product or specification, it means the month in which it is made available for order.

1

Field Configuration Function

Support for Non-Contact Displacement Transducer and Addition of Other functions

Flexible setting according to specifications of the rotating machine

(Field Configuration Function)

Compatible with a wide range of monitoring applications

(Support for Non-Contact Displacement Transducer)

Up to now, settings such as measurement range had to be configured at the time of ordering, but field configuration allows the user to change the settings by himself / herself, and can flexibly respond to the specifications of the rotating machine even on site. This leads to shorter lead times and less spare parts needed for the customer.

In addition, by supporting non-contact displacement transducers, it is possible to monitor not only rotating machines using roller element bearings, but also rotating machines with flexible rotors such as compressors and gas turbines using sleeve bearings.

Note: In order to use this function, please use the combination of products listed on the next page.

■ Function upgrade details

- 1) Addition of field configuration function (See Point 1)
Use the setting software "VM-25S01 Device Config" to set the input transducer, measurement range, cutoff frequency, recorder output settings can be changed freely according to the monitored machine.
- 2) Support for non-contact displacement transducer
- 3) Addition of Peak Hold Function
Even after rotating machinery shuts down, the maximum value of vibration and the elapsed time can be viewed in Device Config and Modbus / TCP communication. By checking the maximum value and elapsed time of vibration at each measurement point, it is easier to determine the inspection range of the rotating machine.
- 4) Addition of Product lineup (see point 2)
- 5) Addition of display mode
Added a mode to display the GAP voltage for 1 minute continuous.
- 6) Addition of Burnout function
Recorder output controlled during burnout (abnormal input) can now be selected from either 0% (1V / 4mA) or 0V / 0mA.
- 7) Addition of alarm status display
The alarm status of DANGER and ALERT can now be checked on the indicator light of the VM-25 monitor main unit and the device configuration.

Point1 Settings can be changed according to the specifications of the rotating machine with VM-25 Device Config.

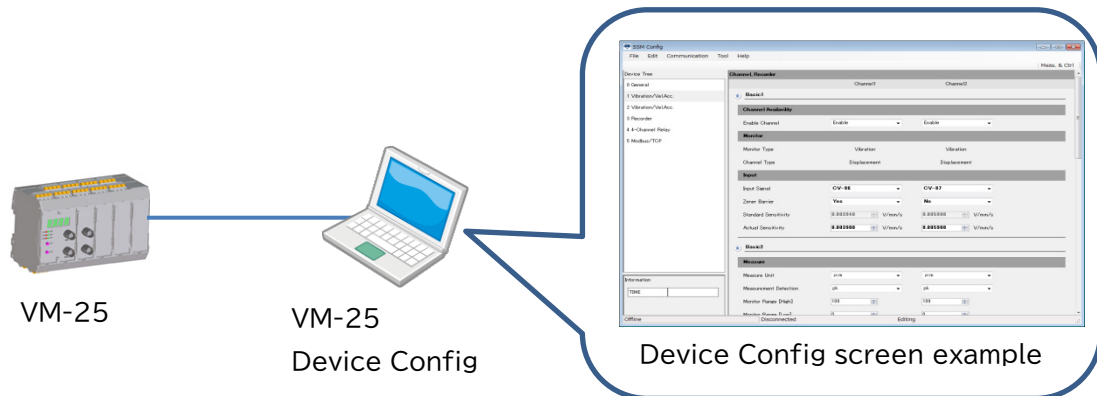

Point2 Product Lineup

Vibration measurement	Recorder output (Isolated)	Relay output	Modbus/TCP	Model
2ch	—	—	Yes	VM-25M00-151-01-00-00-00-00
2ch	—	4ch	Yes	VM-25M00-151-01-00-21-00-00
2ch	4ch	—	Yes	VM-25M00-151-01-00-26-00-00
2ch	4ch	4ch	Yes	VM-25M00-151-01-00-26-21-00
4ch	—	—	Yes	VM-25M00-151-01-01-00-00-00
4ch	—	4ch	Yes	VM-25M00-151-01-01-21-00-00
4ch	—	8ch	Yes	VM-25M00-151-01-01-21-21-00
4ch	4ch	—	Yes	VM-25M00-151-01-01-26-00-00
4ch	4ch	4ch	Yes	VM-25M00-151-01-01-26-21-00
4ch	4ch	8ch	Yes	VM-25M00-151-01-01-26-21-21
6ch	—	—	Yes	VM-25M00-151-01-01-01-00-00
6ch	—	4ch	Yes	VM-25M00-151-01-01-01-21-00
6ch	8ch	—	Yes	VM-25M00-151-01-01-01-26-26
8ch	—	—	Yes	VM-25M00-151-01-01-01-01-00

■ Support information of related products

When using this function, be sure to use the product version / software version listed below.
Older versions do not support those functions.

Hardware

Model	VM-25M00-151-XX-XX-XX-XX-XX
Product Version	Ver.B
Version number location	

Software

Model	VM-25S01
Product Name	VM-25 Device Config
Software version	1.1.0.0



When using the VM-25 monitor Ver.B or later, be sure to use Device Config of Ver.1.1.0.0 or later.

2 Addition of Automatic Adjustment Function

*For those who are not used to handling measurement instruments!
Adjustments of expert quality are possible.*

Until now, when changing the settings of the input transducer or the measurement range, adjustment work using measurement instruments was necessary. However, the automatic adjustment function allows easy adjustment when changing settings without using measurement instruments.

As a result, there is no need to bring measurement instruments to the site, and even customers who are not accustomed to handling measurement instruments can adjust at the same quality level as experienced personnel.

Note: In order to use this function, please use the combination of products listed on the next page.

Point No need to bring measurement instruments for adjustment when changing settings

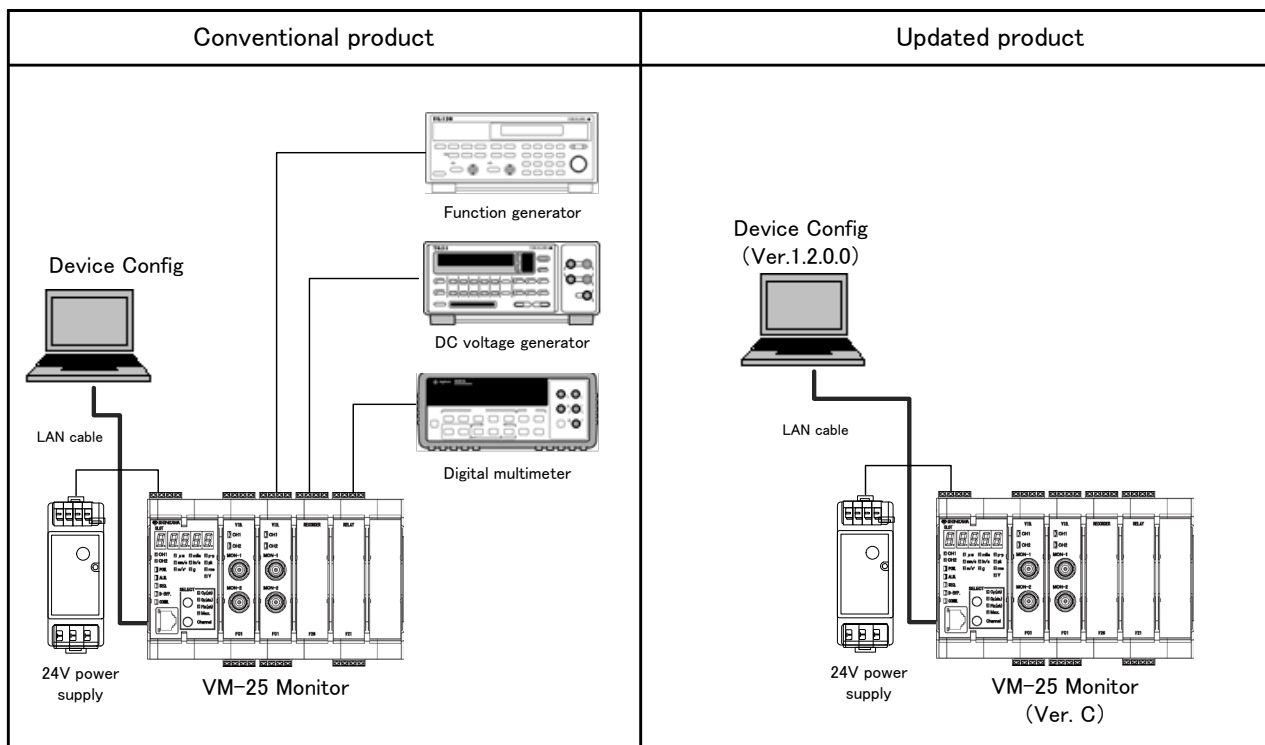

* The measurement accuracy by automatic adjustment is as follows.

- Input / output conversion accuracy: $\pm 1.5\%$ of F.S. at 25 °C
- Gap / Bias voltage measurement accuracy: $\pm 1V$ at 25 °C

However, errors due to aging components are not included.

■ Support information of related products

When using this function, be sure to use the product version / software version listed below.
Older versions do not support this function.

Hardware

Model	VM-25M00-151-XX-XX-XX-XX-XX
Product Version	Ver.C
Version number location	

Software

Model	VM-25S01
Product Name	VM-25 Device Config
Software version	1.2.0.0



Issued in Apr. 2020

Contact to:

SHINKAWA Electric Co. Ltd.

3rd Fl. Shin-kojimachi Bldg.3-3 Kojimachi 4-chome, Chiyoda-ku, Tokyo
102-083, Japan
Tel : +81-3-3263-4417 Fax : +81-3-3262-2171
E-mail : st-mkt@shinkawa.co.jp
Web : <http://www.shinkawaelectric.com/en/>

Manufactured by:

SHINKAWA Sensor Technology, Inc.

4-22, Yoshikawakogyodanchi, Higashihiroshima-shi, Hiroshima,
739-0153, JAPAN
Tel : +81-82-429-1118 Fax : +81-82-429-0804
E-Mail : info@sst.shinkawa.co.jp
Web : <http://www.sst-shinkawa.co.jp>

* Specifications, outline drawings and other written information can be changed without notice.